



WALL MOUNTED UNDERWATER LED SWIMMING POOL LIGHT



HIDRO-LUMEN

INSTALLATION AND MAINTENANCE MANUAL

Please read this operation manual carefully and keep it for future reference.



WARNING

1. Only a licensed or certificated electrician or a qualified serviceman is allowed to install or maintain this product.
2. Must be installed in accordance to the requirements of your government standard or local authorities.
3. Before servicing the light, disconnect the power supply from the circuit breaker. Failure to do so could result in serious injury, death and or damage to the property.
4. Never handle it with wet hands and feet.
5. This light is design for use only when fully submerged in water.
6. Never operate this light for more than 1 minute unless it is totally submerged in water.
7. All lights are required to be disconnected from the main electricity before any operation of maintenance.
8. Maximum depth range for the light installation: 1-10 meter.
9. Maximum water temperature range for the light: -20°C-38°C.

1. Technical Parameters

Standard Input Voltage: 12V/24V AC/DC

SMD 2835 LED			SMD 5050 LED
<input type="checkbox"/> 18W	<input type="checkbox"/> 35W	<input type="checkbox"/> 40W	<input type="checkbox"/> 25W

Dimension: $\Phi 240 \times 42 \text{mm}$

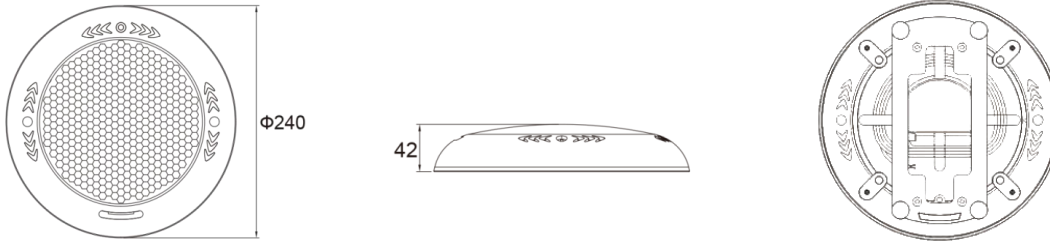

2. Installation

2.1 Preparing to Installation

1. Make sure the pool and its electrical system meets the requirements of the current national or local electrical codes and ordinances.
2. This light can be installed in both concrete pools and fiber glass pools.
3. This light is designed to be used in new pools and/or pools with existing surface mounted lights that need replacement.
4. Use only good quality stainless steel screws or screws provided along with the light.
5. The light must be used or operated while fully submerged underwater only. Never switch on the light if it is not underwater.

2.2 Installation Notes

1. Make sure to install the bracket on a vertical wall of the pool.
2. Make sure the top of the light should be at least 450mm below normal water surface.
3. Reserve at least 150mm long backup wire wrapping on the back of the light, for the convenience of replacing.
4. The junction box or the 12V low voltage transformer, should be located at least 300mm above the water surface, at least 200mm above the ground, and at least 1200mm from the edge of the pool.
5. The light fixture and all metal parts that are within 250cm of the pool must be properly protected with non-ductile materials and that the connections must be waterproof.
6. To achieve synchronization, make sure all the lights are installed correctly on model and characteristics as the one being replaced.

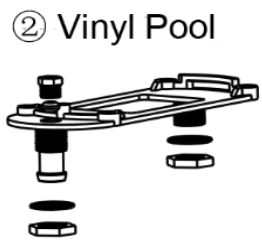
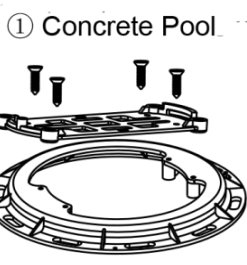
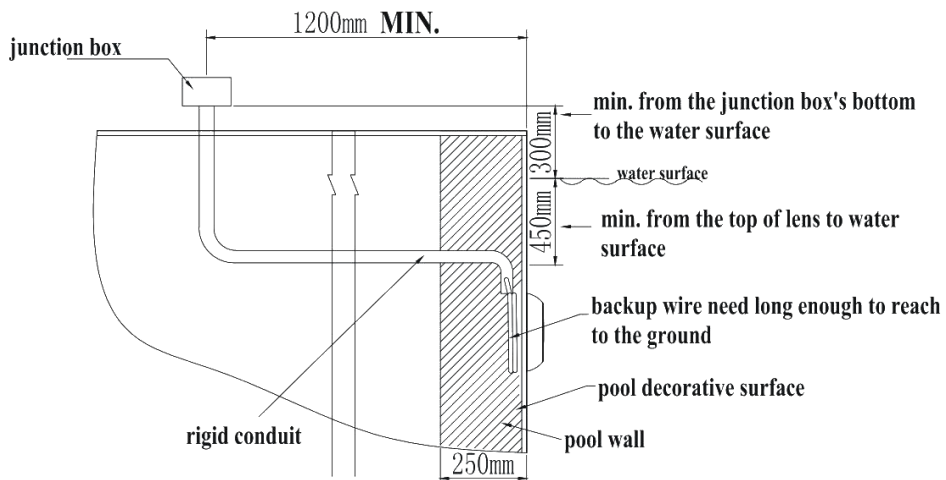
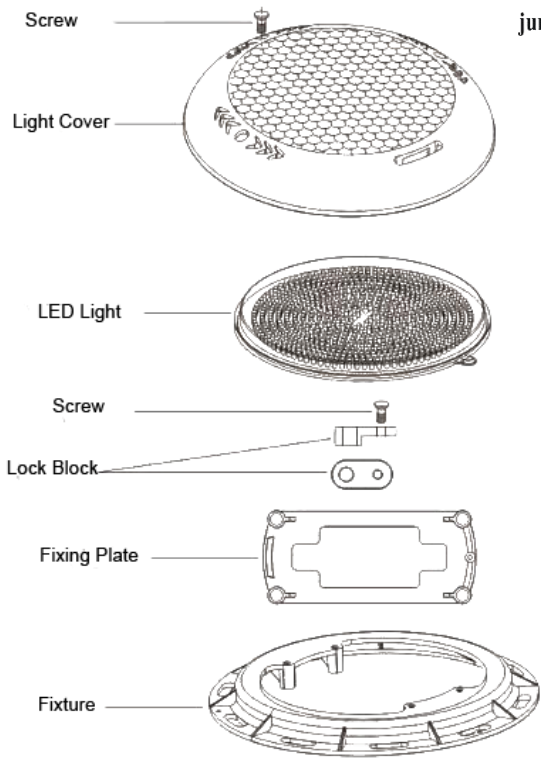

1-Set up for Concrete Pool

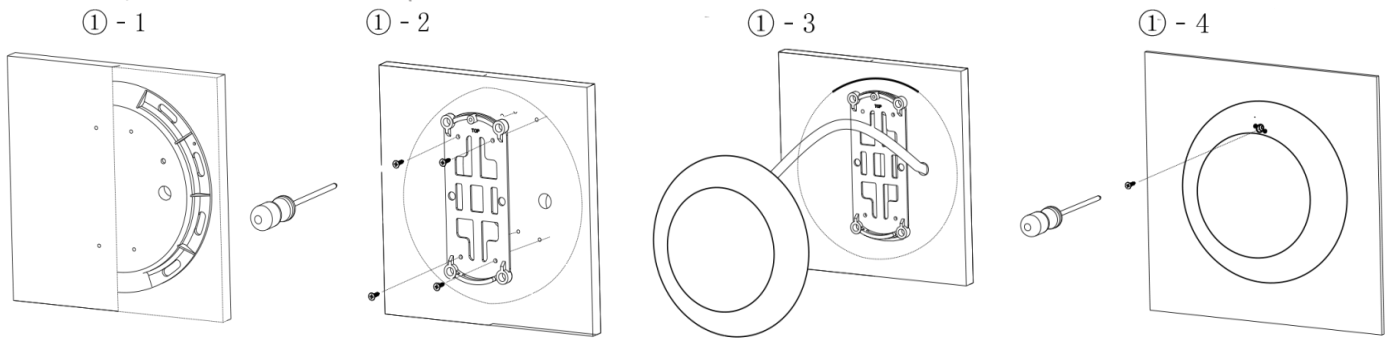

2-Set up for Vinyl Pool

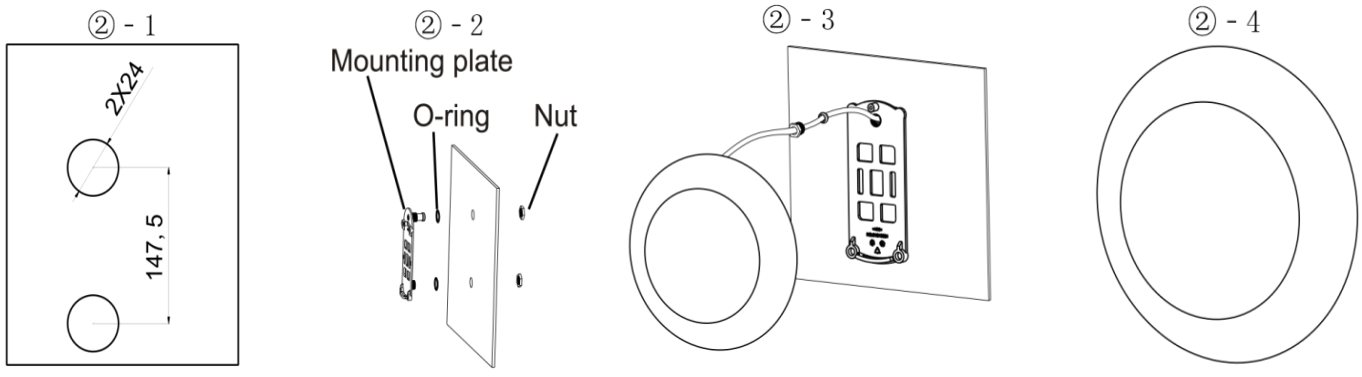

3. RGB Light Color Control Operation

16 pre-programmed color modes of RGB light:

1	BLUE: static blue	9	R-G-RG slow animation
2	RED: static red	10	B-G-BG slow animation
3	GREEN: static green	11	R-B-RB slow animation
4	RB: static purple	12	RB-BG-RG slow animation
5	BG: static cyan-blue	13	R-G-B fast animation
6	RG: static yellow	14	B-G-R fast animation
7	RGB: static white	15	Six colors fast animation
8	RGB change gradually to G/R/B	16	R-G-B slow animation

Remark: When the lights without internal controller option, the light programs will keep changing by fixed automatic cycle switch.

RGB Operation:

1. Any of the 16 modes can be selected with the **ON/OFF switch** of your pool lights.
2. Turn the light **ON**. The **first** time the light is turned on, the color begins with **Blue** (mode 1). The 16 color modes will begin to run automatically.
3. To change the color, turn the light OFF and then ON within 1.5 seconds. Continue turning OFF and ON until the desired light color mode is reached. When the light is turned OFF for more than 1.5 seconds, it will return to the beginning of the color cycle (mode 1).

Note 1: If a **remote control** device is being used, the color modes can also be selected with the controller. One remote control device can be adapted to 30 pool lights simultaneously within 100 meters.

Note 2: If the light is used with **Direct Current (DC)**, a **DMX 512** control and **WIFI** control is available.

4. Maintenance and Replacement

1. There is no maintenance required for this light. It is designed to be used only once, meaning that replacement is necessary if it becomes defective. The repairing is impossible.
2. Before servicing the light, always disconnect power at the circuit breaker to it. Make sure there is NO voltage supplied to the light.
3. To replace the light, unfasten it from the bracket. Make sure the new light is the same switch.

5. Warranty

1. The manufacturer warrants this led underwater light against defect in materials and workmanship for a period of two (2) years from the date of purchase.
2. This warranty is limited to the first retail purchaser, it is not transferable, and does not apply to products that have been moved from their original installation sites. This warranty does not cover failures or malfunctions from improper installation and/or operation.
3. The manufacturer is not responsible in any circumstances for assembly, installation or start-up of any electric components which have been inserted or handled at locations other than its own premises.
4. The liability of the manufacturer shall not exceed the repair or replacement of defective parts. It specifically excludes liability for direct, incidental or consequential damages.