



# SoleFish Pool Robot



## **INSTRUCTION MANUAL**

Note: Subject to update by manufacturer without notice in advance

## **Important Precautions**

1. In order to prevent severe damage to the cleaner, never power on the unit when it is outside of the swimming pool.
2. The power cord must be connected to an appropriate earthed socket.
3. Do not operate the cleaner when people are in the pool.
4. Ensure the cable hook is locked to the ring before immersing the cleaner into water. When lifting the cleaner out of the water, always use the ring and never the cable.
5. For optimal performance, before power on make sure that there is no air left inside the cleaner (no more air bubbles coming from the cleaner and the cleaner is fully submersed on the pool bottom).
6. Do not try to move the floaters along the electrical cable. Leave them always in the original positions.
7. Before power on, make sure the cable is fully released to avoid any winding, which could affect the cleaner's performance or cause damage.
8. The filter bags should be cleaned every time you use the unit. This will prevent that the dirty filter bags affect the normal operation of the cleaner.
9. The cleaner should be stored in a cool and ventilated place, away from direct sunlight, when not in use.
10. The power supply unit should be placed in a shaded area. In order to avoid overheating and potential damage of components, never cover the power supply unit.
11. Only authorized after sales service personnel should open the cleaner's power supply unit and motor assembly, otherwise the warranty will be invalidated.
12. In order to avoid any accident/damage, it is strongly recommended to connect the caddy with a fixed holder beside the swimming pool by using the safety rope (included in the box).
13. Do not use the cleaner beyond the working environment/conditions stated in this manual.

**Please read this instruction manual carefully before use and keep it for future reference.**



## Contents

I . Introduction.....	P 3
II. Safety.....	P 3
III. Specifications.....	P 4
IV. Components of Swimming Pool Cleaner.....	P 4
V . Preparation Before Operating.....	P 6
VI. Cleaner of Operation.....	P 7
VII. Operation of Remote Control.....	P 9
VIII.Works After Use of Cleaner.....	P10
IX. Helpful Tips.....	P11
X. Trouble Shooting.....	P12
XI. Packing List.....	P13
XII. Warranty .....	P14



## I. Introduction

The automatic swimming pool cleaner is a new type of highly efficient and energy-saving swimming pool cleaning robot. Through its advanced computer controlled program, it can clean the pool walls and bottom automatically. At the same time, it filters the pool water and gets rid of suspended particles.

For safe operation, the cleaner works on 24V direct current. Please read this user manual carefully before use.

## II. Safety

### 1. Position of Power Supply Unit

The caddy with power supply unit should be properly positioned so that the cleaner can reach all the corners of the swimming pool, and must be at a minimum distance of 3.5 meters from the edge of the pool.

Note: Power supply unit should be placed in a shaded area during operation.

### 2. Requirements for Power Supply

Before connecting the power supply to the cleaner, please check that the rated voltage and frequency (hertz) of your home correspond to the one of the unit.

Rated input voltage: 110(120)VAC / 220(230)VAC

Frequency: 50Hz/60Hz



[www.hidro-termal.com](http://www.hidro-termal.com)

### III. Specifications

1. Rated input voltage: 110(120)VAC / 220(230)VAC
2. Frequency: 50Hz/60Hz
3. Output Voltage: DC 24V
4. Rated input power: 200W
5. Rated output power: 150W
6. Frequency of remote control: 2.4G
7. Cable length: 20m/30m/40m
8. Cleaning band width: 358mm
9. Maximum cleaning area: 1250m<sup>2</sup>
10. Filtering capacity: 15m<sup>3</sup>/h
11. Filtering capability: 400µm (400µm filter bags are suggested to be used at the beginning of the season), Optional: 10µm/100µm /200µm
12. Water temperature of use: 10°C - 32°C
13. Creeping speed: 12m/min
14. IP Grade: cleaner-IP68; power supply unit-IPX4
15. Working temperature: 10°C - 40°C
16. Weight of cleaner: 10kg (without cable)

### IV. Components of Swimming Pool Cleaner

1. The Automatic Swimming Pool Cleaner consists of power supply unit, cleaner body, and remote control. The following are the components cleaner (see Fig.4-1/ 4-2/4-3)

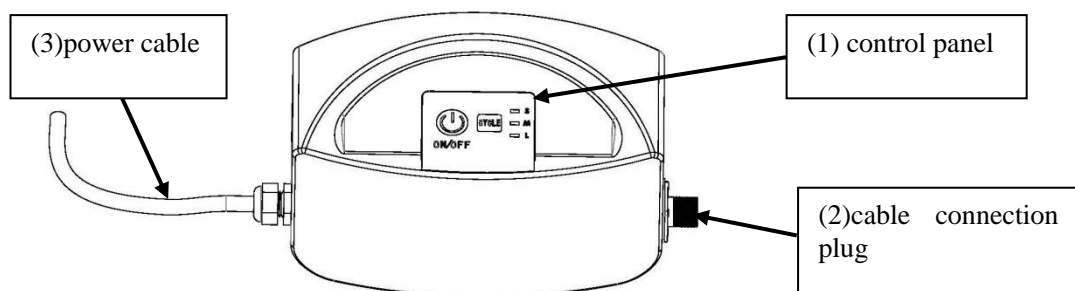

Fig. 4-1 Power supply unit



www.hidro-termal.com

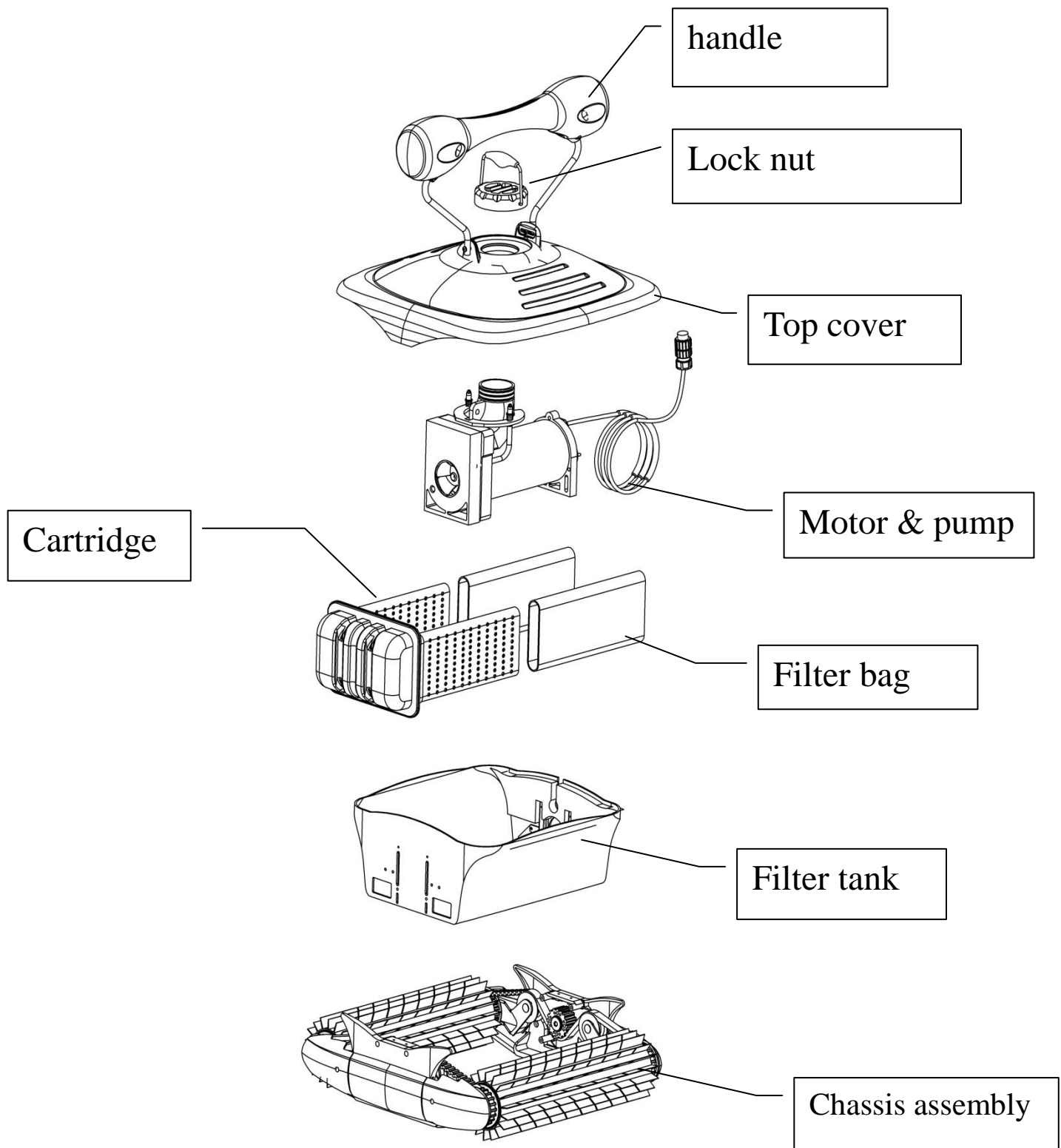

Fig.4-2 cleaner body



Fig.4-3 remote control

## V. Preparation before Operating

### 1. Hitching Cable Hook

Hitch the cable hook (Fig. 5-1-1) to the stationary ring on the lock nut. Carry the stationary ring and put the cleaner into the pool (Fig. 5-1-2). Allow all of the air inside the cleaner to flow out completely (Fig. 5-1-3) from the unit. Then The cleaner can sink to the bottom of the pool (Fig. 5-1-4)

**Warning:** for optimal performance, make sure that there is no air left inside the cleaner (no more air bubbles come from the cleaner and the cleaner is completely submerged on the pool bottom).



5-1-1:



5-1-2:

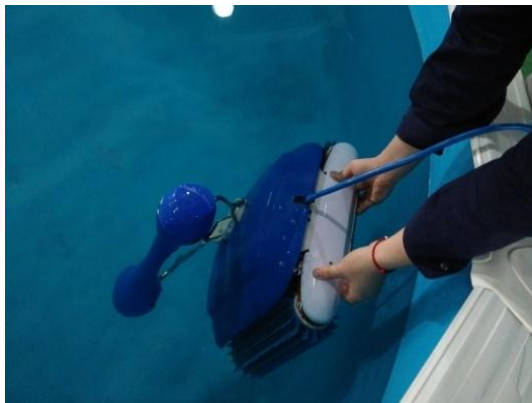

5-1-3:



5-1-4:

Fig.5-1

## 2. Power Connection

Once the cleaner sinks to the bottom of the pool (Fig. 5-1-4), unfold the power cable in the attached package and plug it into the socket on power supply unit . Then plug the cable line into the socket; (note: make sure to plug it in the correct direction and position), and fasten the nuts on both sides of the plug. Connect the power cord to the power socket. The unit is now ready to start cleaning.

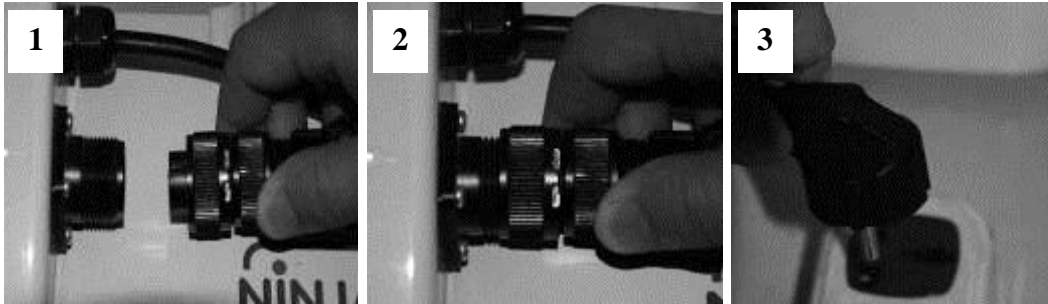

Fig. 5-2 Cable connection

## VI. Cleaner Operation

Panel A

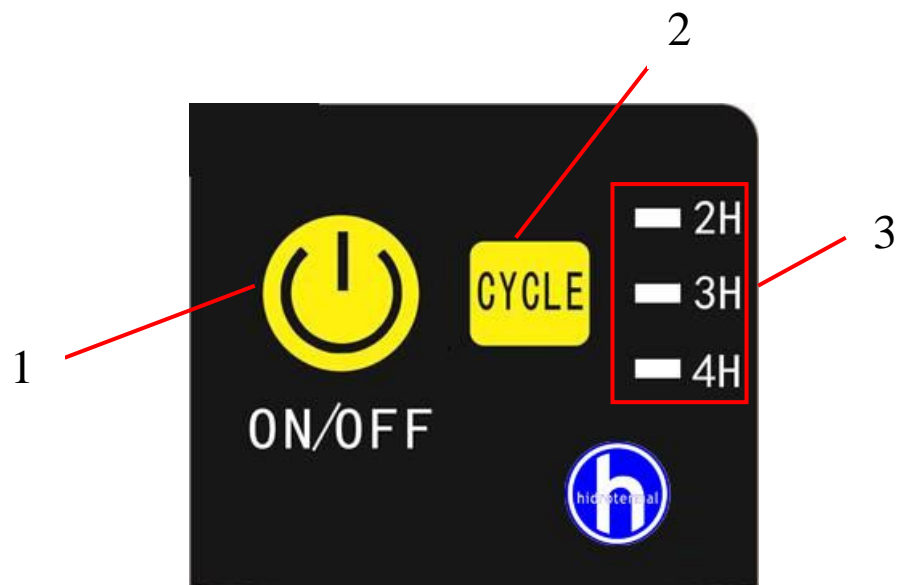

Fig. 6-1



## 1. Buttons & indicator lights instructions

No.	Sign	Specification	Function			
1	ON/ OFF	Switch on or off	Press once the machine start press again machine powered off			
2	CYCLE	Working cycle	After start the machine chose the working cycle			
3	indicator	Working cycle	2H flash	Working under 2 hours cycle		
			3H flash	Working under 3 hours cycle		
			4H flash	Working under 4 hours cycle		
			2H、 3H 、 4H flash together	Working cycle finish		
			Indicator	Meaning	Suggestion	
		Diagnose	2H、 3H flash together with the “BeeBee” alarm	Pump over load	Stop and check anything stuck in impellor or pump.	
			3H、 4H flash together with “BeeBee” alarm	Walking motor over load	Stop and check anything stuck in belt or walking gears.	
2H、 4H flash together with “BeeBee” alarm	Machine out of water		Put machine back into the water.			



## VII. Operation of remote control (RC, if have)

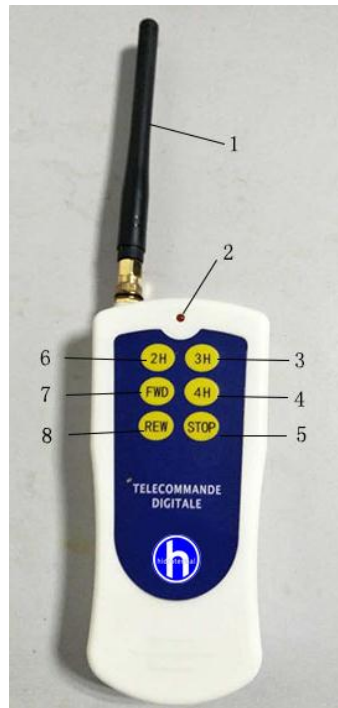

Fig.7-1

### Operation of RC

No.	Sign	Functions
1	antenna	
2	Power light	Power on or off
3	3H	Press this button machine will working under 3 hours cycle.
4	4H	Press this button machine will working under 4 hours cycle.
5	STOP	Press this button machine will stop working.
6	2H	Press this button machine will working under 2 hours cycle.
7	FWD	Press this button machine will moving forward
8	REW	Press this button machine will moving backward



## VIII. Works after use of cleaner

### Removing Cleaner from Pool

The cleaner will power off automatically after one cleaning cycle. Unplug the power cable, pull the cable line slightly and lift the cleaner by carrying the handle or stationary ring on the lock nut (Fig. 8-1).

**Note:**

- 1) In order not to scratch the pool wall or damage the cleaner, avoid the cleaner touching the pool wall during carrying out from pool.
- 2) Before carrying outside from pool, suspend the cleaner above water for about 10-15 seconds to release the water remaining inside the cleaner.
- 3) To carry out the cleaner from pool, please hold the handle or stationary ring only, never pull cable (Fig. 8-1).



Fig. 8-1

Put the cleaner on the edge of pool, open the lock nut, and remove the top cover. Then take out the filter cartridge and take off the filter bags (Fig.4-2).

Clean the debris & silt on filter bags using clean water (Fig.8-2-1), then reset onto filter cartridge. There is a filter outlet added into the cleaner, after using the cleaner, there might be some dirt in it which should also be cleaned. Then put the filter cartridge back into the main frame of cleaner (Fig.8-2-2).

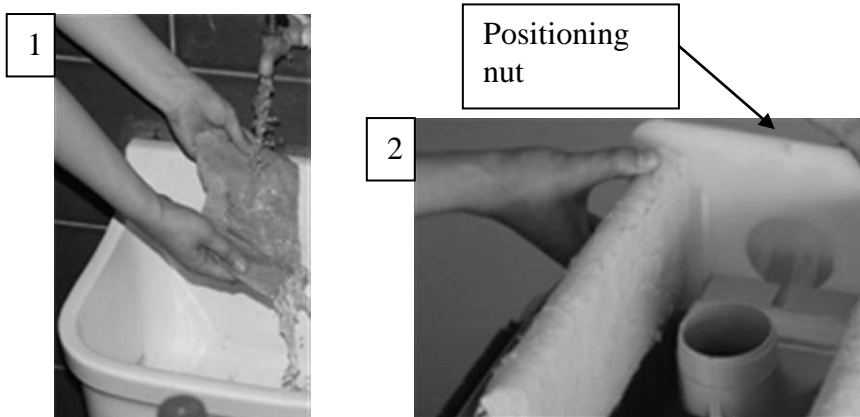

Fig. 8-2



**Note:** There is a positioning nut on the upper part of filter cartridge to avoid any incorrect assembly.

Install top cover and fasten with lock nut.

**Note:** To avoid any effect on the performance of the cleaner, make sure that the cleaner tank is completely inserted into the sealing strips slot of top cover, which should be installed in correct direction. Make sure the cable is in correct position as per Fig. 8-3 to avoid damage.

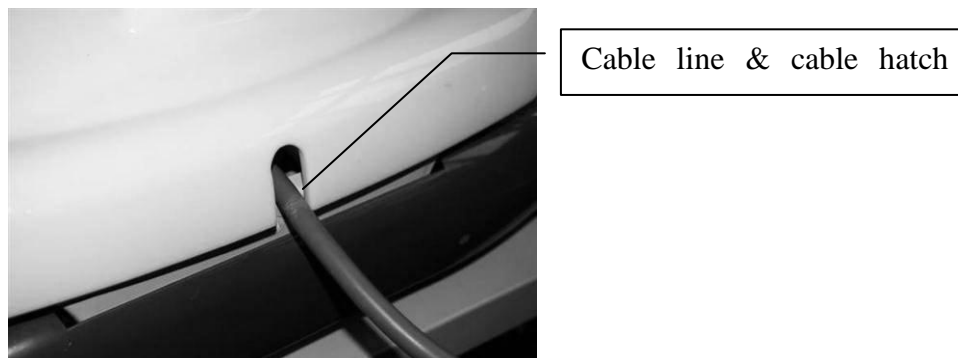

Fig.8-3

## IX. Helpful Tips

1. Different density of filter bags can be used in different seasons.
2. After pulling out the cleaner from the pool each time, please cleaner or change filter bags in time.
3. Ensure PH level of pool water is 7.0-7.2.
4. Ensure temperature of water in pool is 12C-32C.
5. Ensure brushing the cleaning band each time after cleaning for next time use.
6. Do not restart the unit immediately after it stops. Allow 30 seconds before restarting.
7. The cleaner should be stored in a ventilated place with temperature between 5C-40C (The positions of the floaters on the cable should not always be changed to avoid influencing the working condition of the cable). Avoid any direct exposure of cleaner to sunlight.
8. Please contact the agents for filter bags with different density.
9. It's strongly recommend that to fasten the expansion pipe aside the pool, then connect the power supply unit by the provided safety rope to avoid the power supply unit to be pulled into pool by the cleaner.
10. Read carefully this manual including trouble shooting before using the cleaner.



www.hidro-termal.com

## X. Trouble Shooting

Symptom	Possible reason	Corrective actions
Cable twisting or coils up	Cable was not fully released	Unplug power line, release cable
	Obstruction in pool	Remove obstruction in pool
	Excess cable in the pool	Remove excess cable out of the pool and ensure the proper length of cable in pool.
	Gets stuck on main drain cover	Turn off pool filter system
Cleaner does not reach all pool areas	Power supply was wrongly positioned	Place power supply in position so that cleaner can reach all areas
	Pool filter and pump is on	Turn off pool filter system
	Cable not long enough in pool	Release cable
Cleaner does not climb walls properly	Filter bag filled with debris	Replace filter bags
	Large debris in pool	Contact dealer, use thinner filter bags
	Algae on walls	Brush walls
	Water temperature is too high/low	Optimally water temperature between 10C-32C
	Brush worn	Contact dealer, replace brushes
	Material of swimming pool wall too smooth	Contact dealer, replace special brushes
	Cleaner too light—trapped air	Turn off cleaner, exhaust air inside cleaner
	Unsuitable PH level	Check PH level between 7.2-7.6
	The nut on sliding block is not in proper position or loose	Change back to original position, or contact local vendor.
Cleaner does not work	Power cord not connected well	Plug power cord and cable line
	Damaged during transportation	Contact local vendor
	Local rated voltage is not suitable for cleaner	Contact local vendor
Cleaner does not sink	Air inside cleaner	Turn off cleaner, ensure there is no air inside cleaner and let cleaner sink to bottom of pool
Roller/belt cut	Debris blocked in driving system	Contact local vendor
Cleaner float out of water	Cleaner climb too high, air in cleaner	Turn off cleaner, re-exhaust air. Contact dealer if it happens frequently
Cleaner damage	Wrong operation	Contact local vendor



**XI. Packing List (Subject to change or update by manufacturer)**

Item		Name	Model	Quantity (pc)	Note
1	Cleaner	Cleaner		1	In Carton
2		Power supply unit		1	In Carton
3		Manual and certificates, etc.		1	Big Plastic Bag
4		Filter bag		2	Big Plastic Bag
5		Safety rope		1	Big Plastic Bag
6		Battery	23A	1	Mini Plastic Bag
7		Antenna		1	Mini Plastic Bag
8		Remote control		1	Mini Plastic Bag
9	Plastic caddy (As required)	Top handle		1	In Carton
10		Connection part		1	In Carton
11		Plate		1	In Carton
12		Power supply holder		1	In Carton
13		Cable holder		1	In Carton
14		Wheel axle		1	In Carton
15		Wheel		2	
16		Nut	M10	2	Mini Plastic Bag
17		Axle cover		2	Mini Plastic Bag
18		Protecting cover		2	Mini Plastic Bag



## XII. Warranty

This product has passed all quality control and safety tests, conducted by the technical department of the factory

Warranty information:

1. Warranty period is 2 years from the date of delivery and is settled in accordance with the terms established by Directive 1999/44/EC of 25<sup>th</sup> of May regarding guarantees on the sale of consumer goods as well as the local law in the Country of Purchase within the European Union.
2. This warranty is void if the product has been altered, misused, or has been repaired by unauthorized personnel.
3. The warranty extends only to manufacturing defects and does not cover any damage resulting from mishandling of the product by the owner
4. The sales invoice must be presented for any claim or repair during the warranty period

**Please contact your local dealer for any warranty issues.**



### Environmental Programmes, WEEE European Directive



Please respect the European Union regulations and help to protect the environment.

Return non-working electrical equipment to a facility appointed by your municipality that properly recycles electrical and electronic equipment. Do not dispose them in unsorted waste bins.

For items containing removable batteries, remove batteries before disposing of the product.



[www.hidro-termal.com](http://www.hidro-termal.com)